



**On Instructions of RSW Farming  
Oakey Farm, Moreton Valence, Gloucester**

# **SALE OF 229.88 ACRES STANDING MAIZE**

**Crops located at:-**

<b>Oakey Farm, Moreton Valence</b>	<b>124.40 acres</b>
<b>Lynch Farm, Epney</b>	<b>52.63 acres</b>
<b>Manor Farm, Longney</b>	<b>52.85 acres</b>

## **FOR SALE BY INFORMAL TENDER**

**Tender Deadline**  
**Wednesday, 20<sup>th</sup> September 2017 (2.00 pm)**

**Tenders to be submitted to Mr J W Pullin, Voyce Pullin, Knights Farm, Shepperdine Road,  
Shepperdine, Oldbury on Severn, Bristol, BS35 1RL**

Tel: 01454 269486/07736 800760 Fax: 01454 415397 E-mail: jon@voycepullin.co.uk

# Standing Maize - Oakey Farm

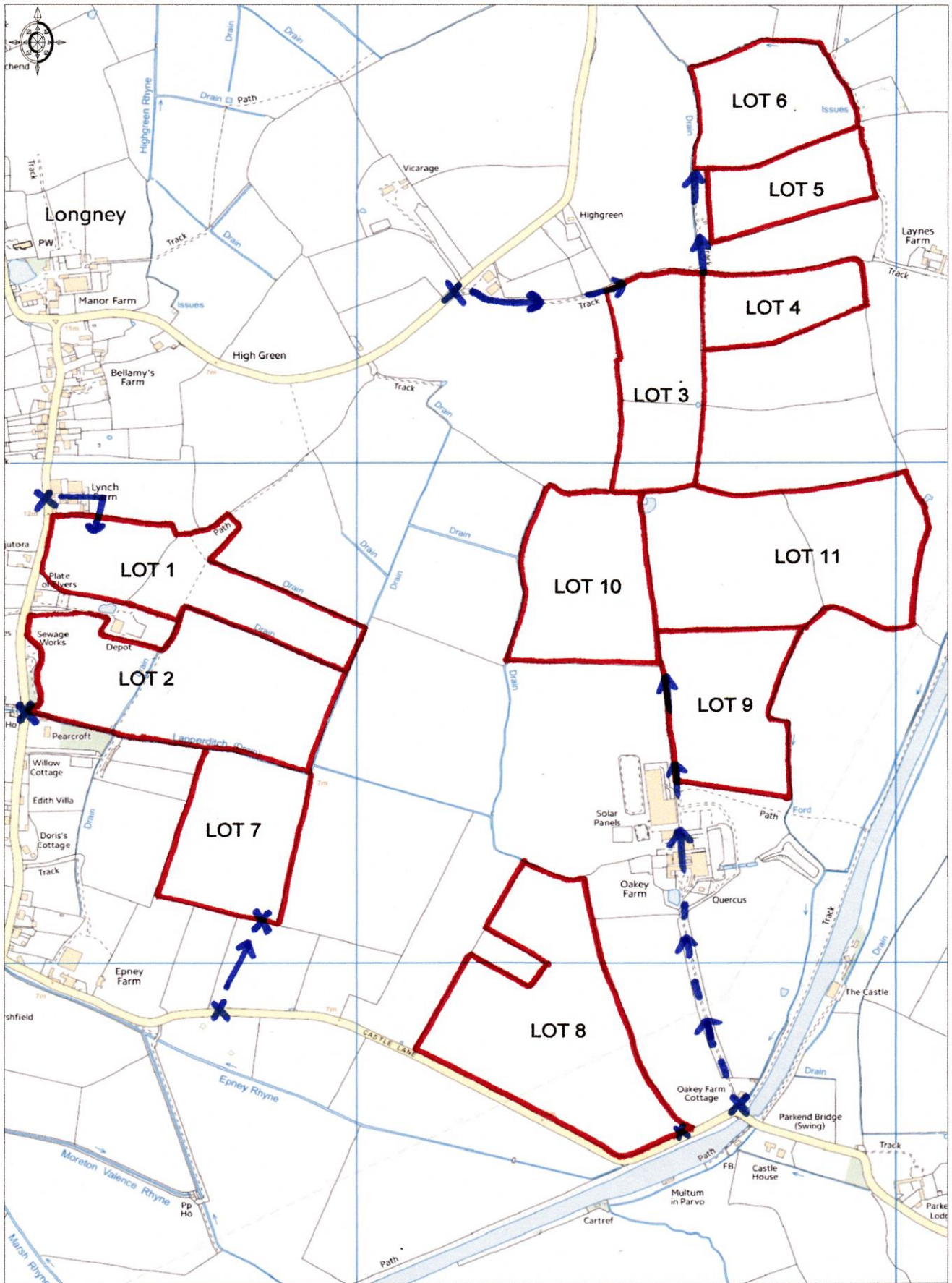

## GENERAL REMARKS, STIPULATIONS & CONDITIONS OF SALE

1. **Introduction** - Voyce Pullin are pleased to receive instructions to offer for sale by Informal Tender the Standing Maize on behalf of RSW Farming.
2. **Method of Sale** – Informal Tender.
3. **Tender Deadline** – Wednesday, 20<sup>th</sup> September 2017 (2.00 pm) – All tenders must be in writing (Tender Form attached or available from the Oldbury Office/Website) marked Maize Tender. Potential purchasers are invited to make offers for the whole or individual lots as detailed, but **NOT** for split lots unless agreed with the Agents.
4. **Viewing** – Please take the opportunity to inspect the crops prior to the Tender deadline. Viewing is acceptable at most reasonable times of day with a copy of these particulars to hand. Purchasers should take special care when viewing the crops and under NO circumstances to drive vehicles into the crops.
5. **Condition of Land** – All fixed equipment on the holding, including gates, posts, hedges and fences, tracks, etc should be left as found, with any damage caused by the purchaser being their responsibility to reinstate. The ground should not be disturbed more than necessary. It is the responsibility of the purchaser to ensure that all private and public roads are also left cleared of all mud and debris so that no hazard to traffic is created.
6. **Insurance** – The purchaser is deemed to have full Public Liability Insurance in place and valid at the time of removing the maize from the farm.
7. **Particulars** – The particulars, plans and schedules attached are presumed to be correct, but are subject to alteration or amendment if any error or omission is discovered. All acreages are approximate.
8. **Payments** – All crops must be paid for on receipt of invoice or within 10 days of the tender deadline. No crops can be cut until payment has cleared with the Agents.
9. **Conditions of Sale** – The Agents usual conditions of sale apply and in the case of any dispute their decision will be final and binding.
10. **Important** – The crop only becomes the property of the buyer on receipt of good payment however becomes their responsibility on acceptance of tender. It is also agreed that any accepted buyer will act in good faith and make best and reasonable efforts to cut and remove the crops as soon as it reaches maturity and that harvesting conditions are suitable.
11. **Schedule of Lots** (*Please see attached plan*)

*At Lynch Farm, Longney, Gloucester, GL2 3SJ*

Lot 1	2 enclosures	8.9 ha	21.99 acres	Agiraxx
Lot 2	2 enclosures	12.4 ha	30.64 acres	Agiraxx

*At Manor Farm, Longney, Gloucester, GL2 3SL (adjacent Grain Store)*

Lot 3	2 enclosures	6.73 ha	16.63 acres	Kroft
Lot 4	1 enclosure	4.42 ha	10.92 acres	Kroft
Lot 5	1 enclosure	4.23 ha	10.45 acres	Kroft
Lot 6	1 enclosure	6.01 ha	14.85 acres	Kroft

*At Oakey Farm, Moreton Valence, Gloucester, GL2 7NF*

Lot 7	1 enclosure	6.84 ha	16.90 acres	Agiraxx/Kroft
Lot 8	1 enclosure	14.21 ha	35.11 acres	Agiraxx/Kroft
Lot 9	1 enclosure	7.13 ha	17.61 acres	Agiraxx/Kroft
Lot 10	1 enclosure	8.25 ha	20.39 acres	Agiraxx/Kroft
Lot 11	2 enclosure	13.92 ha	34.39 acres	Agiraxx/Kroft

12. **Disclaimer:** The particulars are intended to give a fair and substantially correct overall description for the guidance of intending purchasers and do not constitute part of any offer or contract. No responsibility is assumed for the accuracy of individual items and all descriptions, references to condition, permission for use and occupation and their details are given in good faith and are believed to be correct. Any intending purchaser should not rely on them as statements or representations of fact but must satisfy themselves by inspection or otherwise as to the correctness of each of them.
13. **General Directions:** All crops are located at or close to Oakey Farm, Moreton Valence, GL2 7NF. If travelling from distance Exit M5 at J12 and head north towards Gloucester on the B4008 for 0.5 mile, at the Garage/McDonalds roundabout head south on the A38 for 1.3 miles and turn right onto Castle Lane. Continue for 0.5 mile and travel over the canal immediately after this turn right into Oakey Farm Driveway.

Directions to Crops and Points of access – At Oakey Farm, GL2 7NF.

Lots 9, 10 and 11 - Follow the general directions above entering into Oakey Farm, access to Lots 9, 10 and 11 is through the farm buildings and along tracks.

Lot 8 - Follow above directions to Oakey Farm – do not turn into Oakey Farm, but continue a further 100m along Caste Lane and the access gate into Lot 8 is on your right hand side.

Lot 7 – From the entrance into Oakey Farm continue along Castle Lane for about 0.5 mile and access to the maize is across a field of pasture which adjoins Castle Lane.

Lynch Farm, GL2 8SJ

Lots 1 and 2 – Travel from Oakey Farm in a westerly direction along Castle Lane towards Longney. Access to Lot 1 is through the farm buildings at Lynch Farm. The entrance to Lot 2 is the gateway just above the property known as Peasecroft and Willow Cottage.

Manor Farm, Longney, GL2 3SL

Lots 3-6 – From Oakey Farm head west along Castle Lane, past Lynch Farm and to the triangular junction. At the junction Manor Farm faces you. Turn right towards Hardwicke and turn in along the track adjacent to the Grain Store. If you reach the property “Highgreen” you have gone too far. Tracks give access to the individual lots.

14. **Agents** – Voyce Pullin, Oldbury Office, Knights Farm, Shepperdine Road, Shepperdine, Oldbury on Severn, Bristol, BS35 1RL Tel: 01454 269486/07736 800760, Fax: 01454 415397, e-mail: jon@voycepullin.co.uk

**INFORMAL TENDER**  
**STANDING MAIZE**  
(Moreton Valence, Epney and Longney)



**ALL OFFERS ARE TO BE SUBMITTED TO THE ADDRESS BELOW  
BEFORE 2.00pm on WEDNESDAY, 20<sup>TH</sup> SEPTEMBER 2017**

Voyce Pullin, Knights Farm, Shepperdine Road, Shepperdine, Oldbury on Severn, Bristol, BS35 1RL  
Tel: 01454 269486 E-mail: jon@voycepullin.co.uk

**1** All offers should be completed on this form and returned in an envelope clearly marked **“Standing Maize”**. E-mailed forms/Offeres are acceptable. Please e-mail to jon@voycepullin.co.uk.

**2** The successful bidder will be notified as soon as possible after the Deadline Date.

**3** Whilst it is the Client’s intention to sell the Standing Maize, our client does not bind themselves to accept the highest, or indeed, any offer.

<b>Name of person(s) making offer</b>	
---------------------------------------	--

<b>Address of person(s) making offer including Telephone Number:</b> <i>Please ensure you provide us with a contact telephone number to allow us to contact you after decision has been made.</i>	Tel:
---	------

<b>Amount of offer</b>	Lot (s)	Price per Acre £
	Lot (s)	Price per Acre £

<b>Any other Comments:</b>	
----------------------------	--

**Please sign and date (where possible) below:**  
**Signed:**  
  
**Dated:**

**If you require any further information please contact us on 01454 269486**